

# WTO

## *nanoFlex*<sup>®</sup>

The new quick change system.  
Compact design and high precision.

Minimal investment, maximum expandability.



Designed  
for  
Swiss Type  
Lathes

# nanoFlex®

The perfect combination: ER collet chuck and modular quick change system in one toolholder.

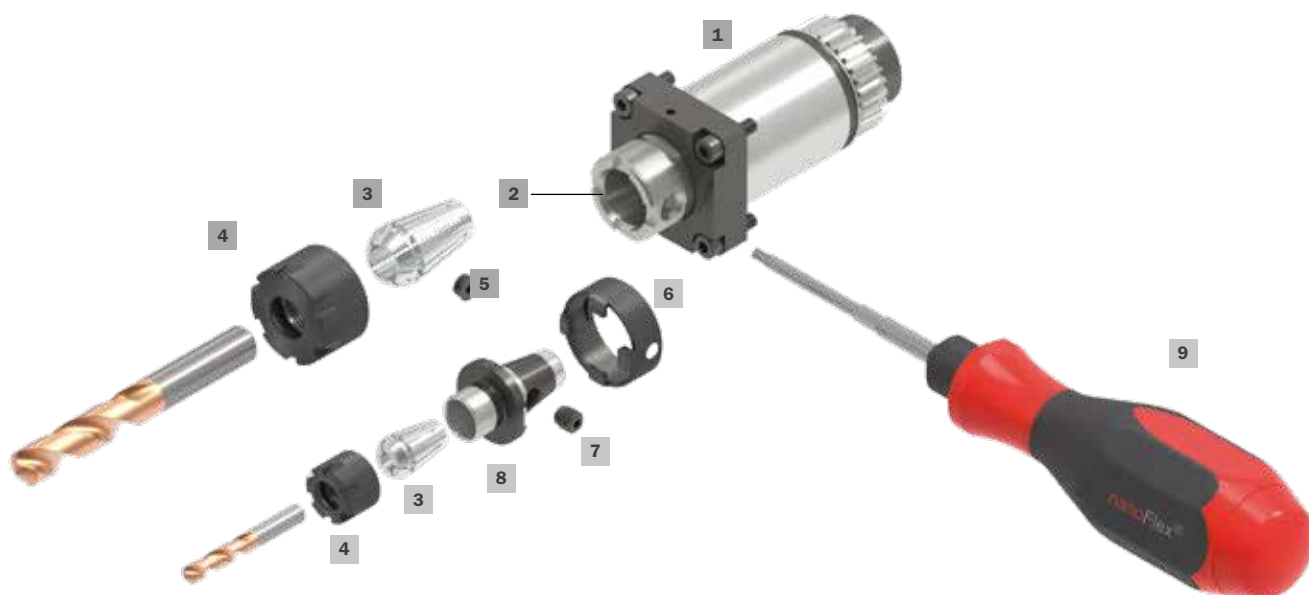

*nanoFlex® chuck prepared for adapter clamping.*

- 1 - Toolholder
- 2 - nanoFlex® chuck
- 3 - ER collet
- 4 - Collet nut
- 5 - Plug screw for spindle side
- 6 - Drive ring for torque transmission of the nanoFlex® quick change adapter
- 7 - nanoFlex® clamping screw
- 8 - nanoFlex® quick change adapter
- 9 - One-hand wrench with set torque value to clamp and unclamp the nanoFlex® quick change adapters
- 10 - Drive dogs for torque transmission
- 11 - Taper for ER collets and nanoFlex® adapter



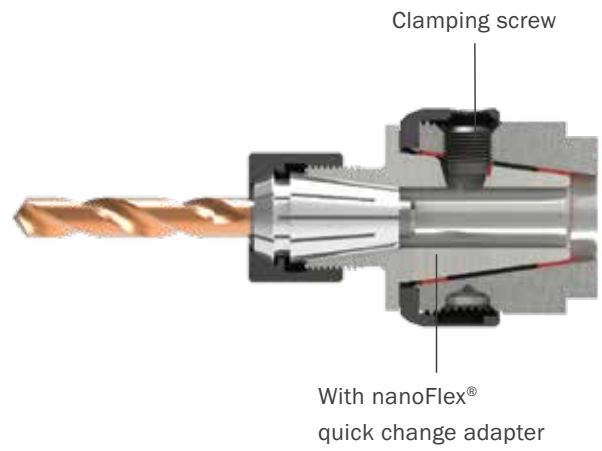
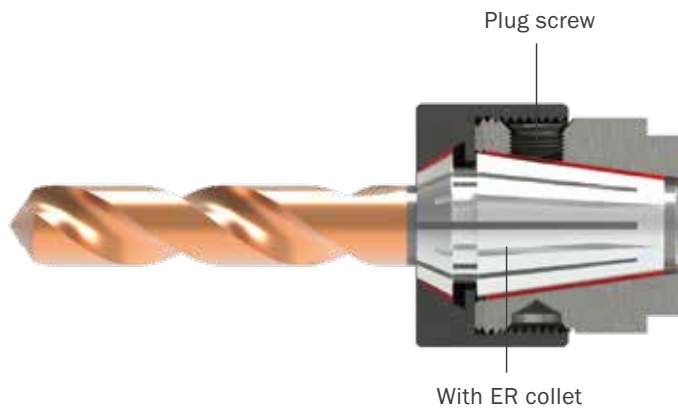

Regular tool clamping using collets.

Tool clamping using quick change adapters.



## Handling using quick change adapters

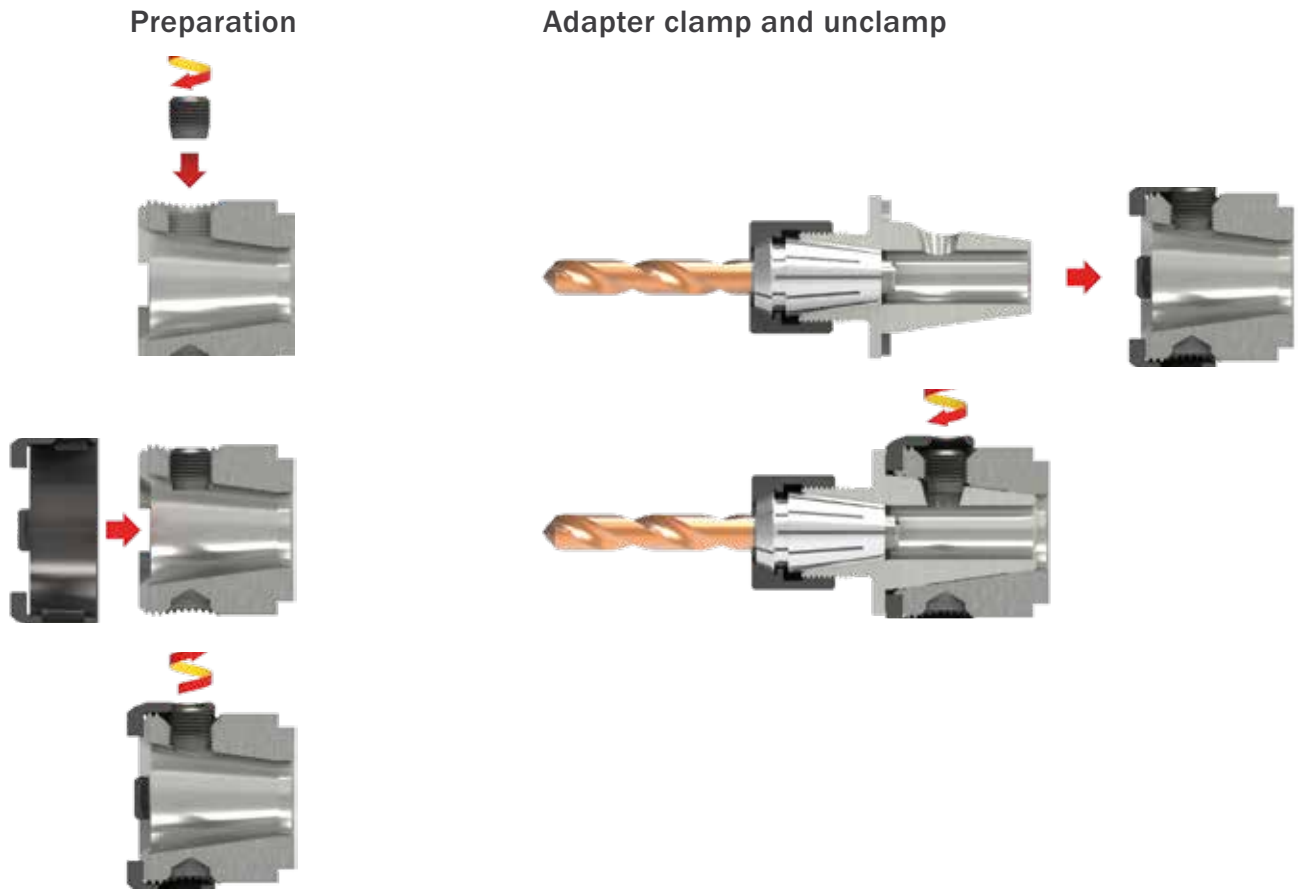

## Handling using collets

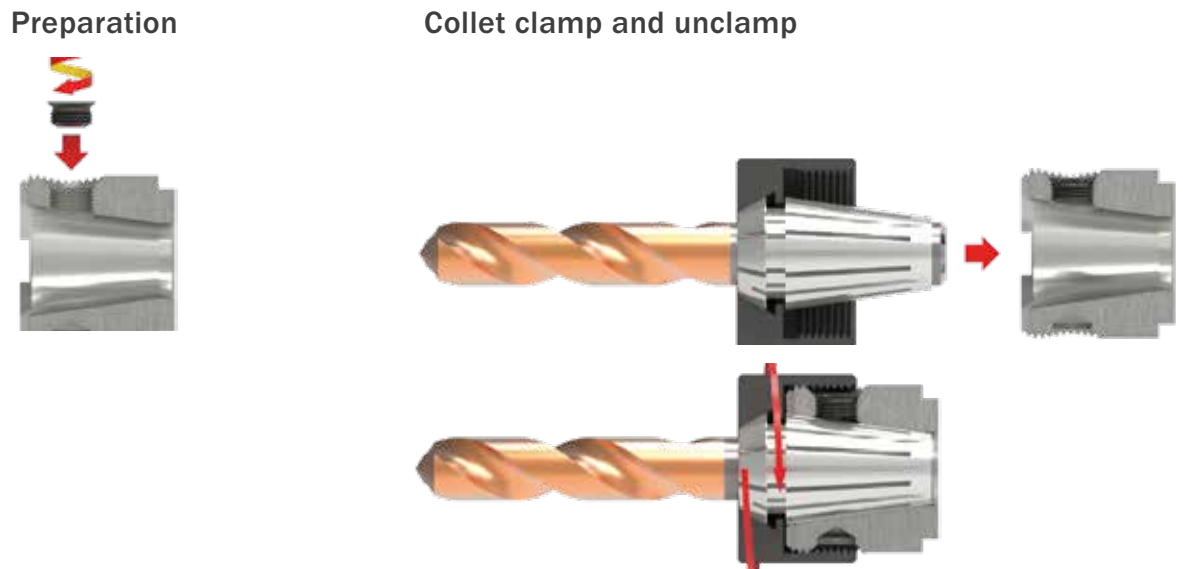



## Cylindrical shank holder

with cylindrical shank and flat.

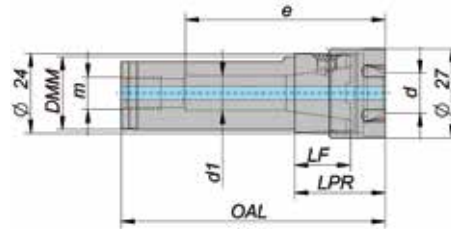
For flexible use of ER collets and nanoFlex® adapters in boring bar and sleeve holders.





Size	Item No.	DMM	d min.	d max.	LF	LPR	OAL	d <sub>1</sub>	m	e			
ER-16NF	NF16-SSH-075-A	¾"	0.5	10	17	28.5	78.5	10.5	G <sup>1</sup> / <sub>8</sub> "	60.5	NF16-SCN-A	107520005	NF16-SPL-A
ER-16NF	NF16-SSH-022-A	22	0.5	10	17	28.5	80	10.5	G <sup>1</sup> / <sub>8</sub> "	60.5	NF16-SCN-A	107520005	NF16-SPL-A
ER-16NF	NF16-SSH-025-A	25	0.5	10	17	28.5	78.5	10.5	G <sup>1</sup> / <sub>8</sub> "	60.5	NF16-SCN-A	107520005	NF16-SPL-A

Dimensions in mm. Including clamping nut and plug screw ER-16NF.

## Collet chuck adapter

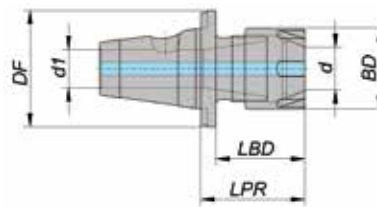
DIN 6499, ISO 15488





Size	Item No.	DF	d min.	d max.	d <sub>1</sub>	BD	LPR	LBD	Collet size		
ER-16NF	NF16-SAD-ER08-A	23	0.5	5	5.5	12	20.5	17.5	ER 8	200508000	107508005
ER-16NF	NF16-SAD-ER11-A	23	0.5	7	7.5	16	20.5	17.5	ER 11	200511000	107511005

Dimensions in mm

## Weldon/Whistle Notch adapter

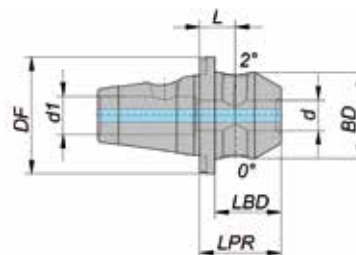
for tool shanks according to DIN 6535-HB and -HE



Size	Item No.	DF	d	BD	LPR	LBD	L	d <sub>1</sub>		
ER-16NF	NF16-SAD-WW06-A	23	6	17	16	13	7	7.5	12882	26071

Dimensions in mm

## Master gauge/Preset master adapter

etched with actual gauge length measurement

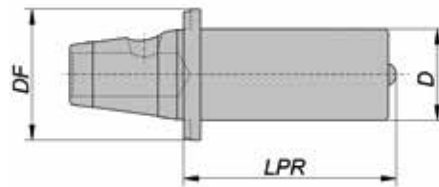





Size	Item No.	DF	D	LPR
ER-16NF	NF16-SMA-A	23	16	37.5

Dimensions in mm

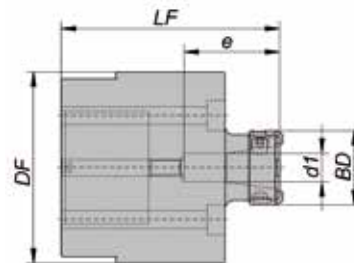
## Mounting and presetting device nanoFlex®

for cutting tool change and presetting of nanoFlex® adapters



Size	Item No.	DF	BD	LF	d <sub>1</sub>	e				
ER-16NF	NF16-SMD-A	70	27	80	10.5	35	NF16-STW-A	NF16-SDR-A	NF16-SCS-A	29205



Dimensions in mm

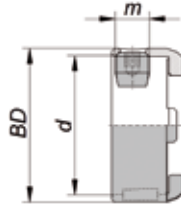

## Drive ring

for use with nanoFlex® adapters



Size	Item No.	BD	d	m			
ER-16NF	NF16-SDR-A	27	24	M6x0.5	10IP	NF16-SCS-A	NF16-STW-A

Dimensions in mm. Clamping screw included

## Torque screwdriver

to clamp nanoFlex® adapters with one hand



**Note:**  
Blade replacable

Size	Item No.		Nm	
ER-16NF	NF16-STW-A	10IP	2.5	109330

Dimensions in mm

## Clamping screw ERNF

to clamp nanoFlex® adapters



Size	Item No.		Nm	
ER-16NF	NF16-SCS-A	10IP	2.5	NF16-STW-A

Dimensions in mm

## Collet nut ERNF

suitable for nanoFlex® spindle collet chuck  
DIN 6499, ISO 15488

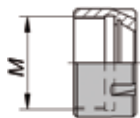

Size	Item No.	M	Nm	
ER-16NF	NF16-SCN-A	M24x1	45	107520005

Dimensions in mm

## Plug screw ERNF

to plug the clamping screw hole



Size	Item No.		Nm	
ER-16NF	NF16-SPL-A	10IP	2.5	NF16-STW-A

Dimensions in mm

# WTO worldwide

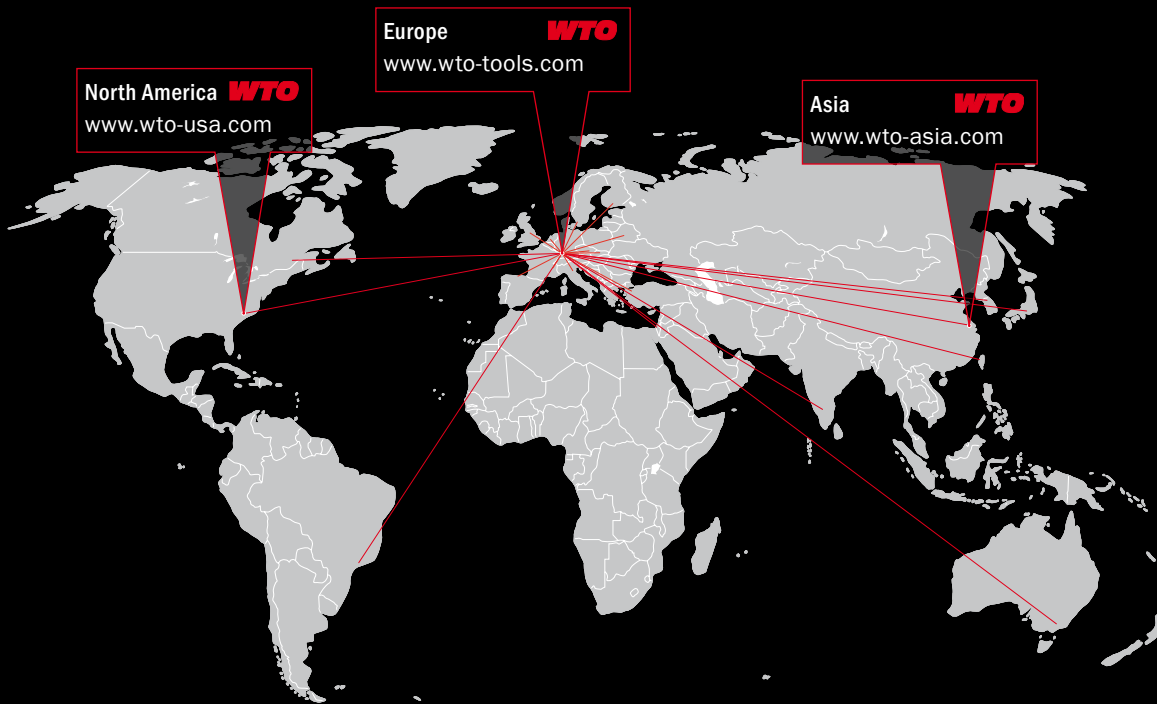

WTO Werkzeug-  
Einrichtungen GmbH  
Neuer Hohdammweg 1  
77797 Ohlsbach  
Germany

WTO Inc.  
13900-F South Lakes Dr.  
Charlotte, NC 28273  
USA

WTO Asia  
WTO Precision Tool Holders  
(Shanghai) Co. Ltd.  
Room 109-110, Building 2  
No. 228 Banting Road  
Jiuting Town,  
Songjiang District  
201615 Shanghai  
China

## Our distribution partners. Competence right there.

**Australia**  
Dimac Tooling Ltd.  
sales@dimac.com.au

**Brazil**  
TF2  
tfdois@tfdois.com.br

**Canada**  
Mittmann Industrial Inc.  
info@mittmann.com

**China**  
Shanghai Gangde  
wtocando@yahoo.com

**Czech Republic**  
ALBA precision, spol. s.r.o.  
info@albaprecision.cz

**Denmark**  
AVN Teknik A/S  
cjo@avn.dk

**Finland**  
Suomen Terätuonti Oy  
myynti@stt.as

**France, east**  
Christophe Archambault  
alm@wto.de

**France, west**  
Christophe Archambault  
car@wto.de

**Great Britain**  
Cutwel Ltd.  
sales@cutwel.net

**Hungary**  
Prevotex Hungary Kft.  
info@prevotex.hu

**India**  
Ulhas Patil  
u.patil@wto-asia.com

**Israel**  
E.Y.A.R. Ltd.  
boris@eyar.co.il

**Italy**  
Prymark srl  
commerciale@prymark.it

**Japan**  
NK Works Co. Ltd.  
k\_samba@nk-works.co.jp

**Korea**  
WTO Office Korea  
is.chon@wto-korea.com

**Mexico**  
Workholding Engineering De México  
info@wem.com.mx

**Netherlands**  
Toologic BeNeLux B.V.  
info@toologic-benelux.nl

**Norway**  
Helge Karlsen Verktøy og Maskin AS  
hkvm@hkvm.no

**Poland**  
ARCO Andrzej Rudenko  
info@arcotools.pl

**Romania**  
SC Elif Trading SRL  
bulent.ozkan@eliftrading.com

**Slovakia**  
ALBA precision s.r.o.  
albaprecision@albaprecision.sk

**Spain**  
ITALMATIC, S.A.  
italmatic@italmatic.es

**Sweden**  
Bonhron & Ewing AB  
info@bonhron-ewing.se

**Switzerland**  
Utilis AG  
info@utilis.com

**Taiwan**  
Kaiko Co., Ltd.  
info@kaiko.com.tw

**Turkey**  
MYK CNC MAKINA SAN. VE  
huseyin.tatlidil@mykcnc.com.tr

**Ukraine**  
„LLC“ SPA Stankopromimport  
info@phoenix-ua.com